

EVERYONE CAN BE A LIFESAVER

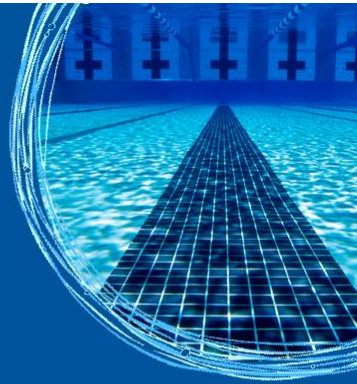

## Assessing the application of safety standards in Australian aquatic facilities.

Matt Griffiths

Royal Life Saving Society - Australia

EVERYONE CAN BE A LIFESAVER

### Background

- Over 1000 aquatic facilities in Australia.
- Variety of resources available to support facility operation including:
  - Federal and State Legislation
  - Australian Standards
  - Codes of Practice and Guidelines relevant to the operation of an aquatic facility
  - RLSSA Guidelines for Safe Pool Operation (GSPO)
- In the 3 years to 2010 Royal Life Saving has assessed 352 facilities against an assessment criteria based on the GSPO



## Aquatic Facility Safety Assessment

- On-site inspection utilising a 227 item checklist covering the following areas of aquatic facility operations:
  - Administration\*
  - First Aid\*
  - Technical Operation\*
  - Facility Design\*, Spa Pools, Dive Pools, Waterslides, Wave Pools, Rivers, Water Features.
  - General Supervision\*
  - Learn to Swim
  - Observation

\* indicates a core section of the AFSA



## Scoring of the Assessment

- Qualification Items – Checklist Items that are considered of particular significance.
- Compliance Score – the AFSA is a compliance assessment and this score lists the total number of compliances against all applicable items. A Checklist Item must achieve a score of 3 (out of 5) or greater to be considered compliant.
- Safety Score – total marks achieved (out of 5) against total available.



## Assessment Process

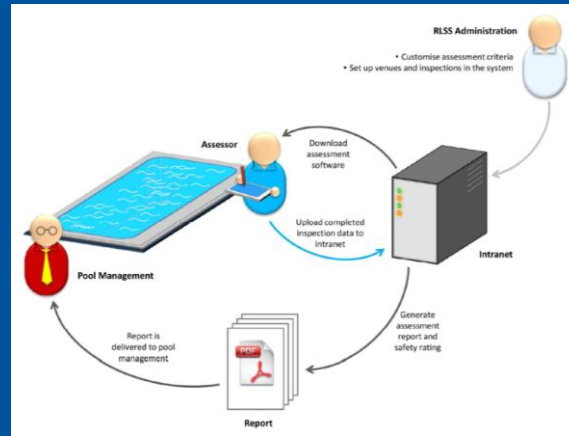

## AIMS

1. To provide a measure of the current application of standards by industry compared with previous years.
2. To identify specific areas of concern from the results of the AFSAs conducted over the three years to March, 2010.
3. To assess the value of a regular policy of regular external auditing via the AFSA.

## METHOD

- Results collated from a randomly selected sample of 100 assessments from each of the following periods:
  - 2008 - 1<sup>st</sup> April, 2007 to 31<sup>st</sup> March, 2008
  - 2009 - 1<sup>st</sup> April, 2008 to 31<sup>st</sup> March, 2009
  - 2010 - 1<sup>st</sup> April, 2009 to 31<sup>st</sup> March, 2010
- Statistical analysis completed using Microsoft Excel



## Results

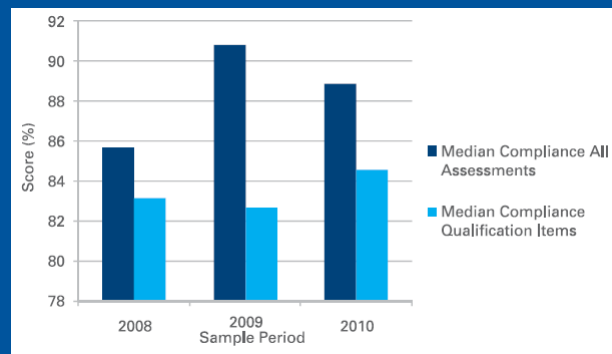

## Section 1 - Administration

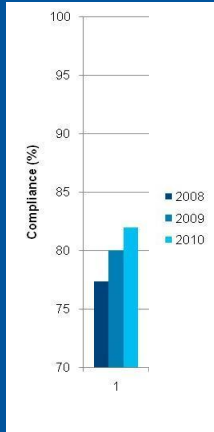

### Examples:

Question 1.3 - *Is the Operations Manual(s) facility-specific?*

Question 1.4 - *Has an Emergency Action Plan (EAP), which includes sections for different scenarios and locations, been developed?*

Question 1.9 - *Do lifeguards undertake in-service training covering all areas of Lifeguard skills?*

## Section 2 – First Aid

### Examples:

Question 2.1 - *Is there a designated First Aid room or area of appropriate size and configuration?*

Question 2.2 - *Is the First Aid room or area easily identified?*

Question 2.4 - *Is there sufficient stock of appropriate First Aid equipment? (Min. requirements specified in assessment)*

Question 2.7 - *Is functioning oxygen equipment available?*

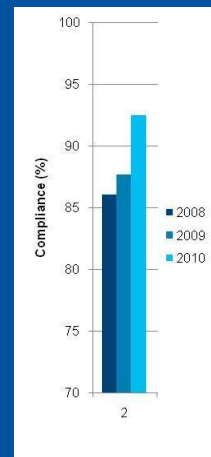

EVERYONE CAN BE A LIFESAVER

## Section 3 – Technical Operations

Examples:

Question 3.17 - Has a Dangerous Goods manifest been prepared?

Question 3.25 - Is signage displayed in plant rooms and chemical handling areas promoting the use of the required PPE (refer question 3.13)?

Question 3.26 - Are all pipes, valves and pumps, controlling water and chemical feeds, clearly labelled?

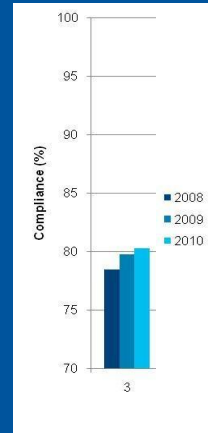

EVERYONE CAN BE A LIFESAVER

## Section 4 – Facility Design

Examples:

Question 4.8 - Are fittings and fixtures flush with pool walls and floor?

Question 4.9 - Are gutters, whether wet-deck or integrated with the pool wall, sufficiently protected to prevent injury through obstruction, entrapment, or tripping?

Question 4.28 - Is the nature of the concourse surface intended to be slip-resistant?

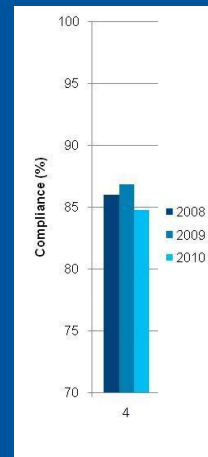

## Signage

**Examples:**

Question 4.14 - *Is there sufficient signage identifying deep water, shallow water, particularly at pool entry points?*

Question 4.55 - *Can the depth signage be seen from within the pool?*

Question 4.56 *Can the depth signage be seen from the pool concourse?*

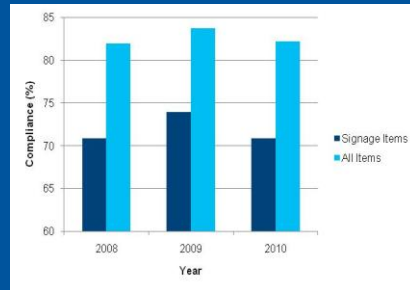

## Section 11 – General Supervision

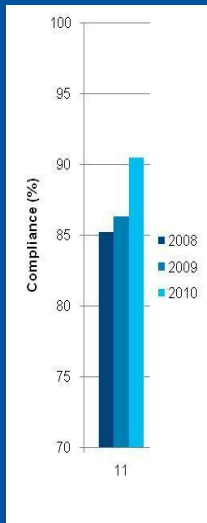

**Examples:**

Question 11.1 - *Are at least two qualified pool lifeguards that hold a RLS Pool Lifeguard Award on duty at any one time?*

Question 11.4 - *What criteria are considered when deploying lifeguards?*

Question 11.10 - *Do lifeguards vary duties and take sufficient breaks to maintain vigilant supervision?*





## Comparison of Facilities undertaking periodic assessments

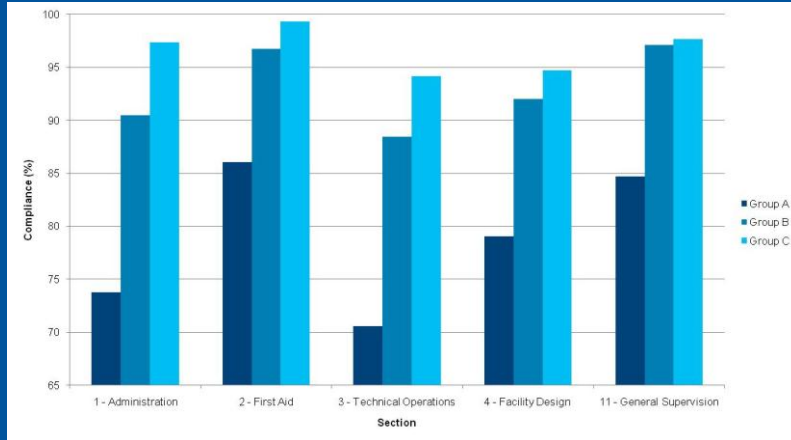

## Recommendations

1. That a policy of regular external auditing via the AFSA be adopted by operators as part of a facility's risk management strategy.
2. That Royal Life Saving engage in consultation with facility operators to identify further strategies that may improve the use of signage at aquatic facilities.
3. That changes to the AFSA be implemented to establish a detailed classification of aquatic facilities.
4. That a representative sample be established to assess the accuracy of the results of the AFSA as a measure of the state of the industry.



EVERYONE CAN BE A LIFESAVER

## For more information:

**Matt Griffiths**

National Manager – Aquatic Industry Services  
Royal Life Saving Society – Australia

**Phone** +61 2 8217 3126

**Email** mgriffiths@rlssa.org.au

**Website** [www.royallifesaving.com.au](http://www.royallifesaving.com.au)

